



**MID-COAST CORRIDOR**  
TRANSIT PROJECT



**Nobel Drive Station**  
**PARKING STRUCTURE OPTION**



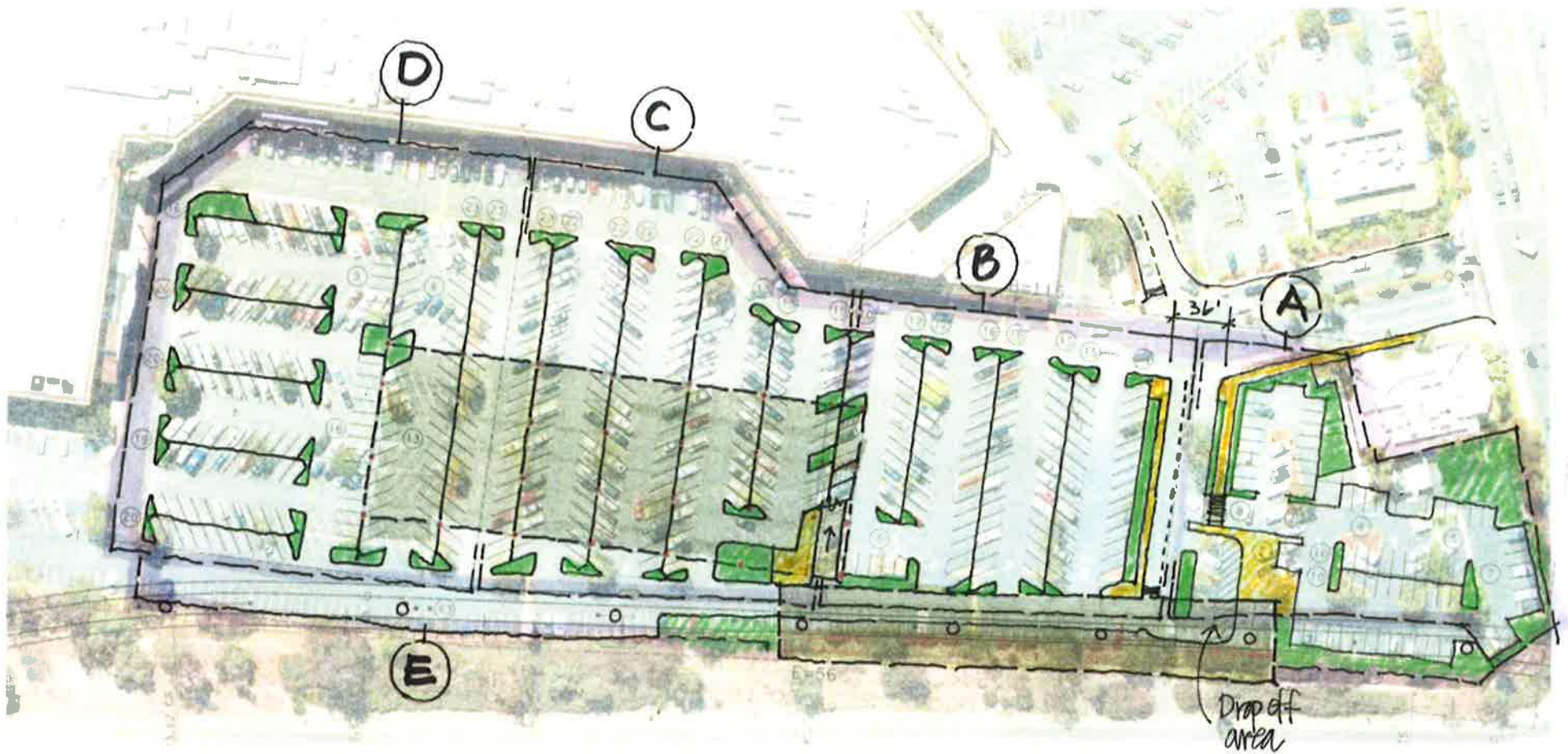

MCCTP Site Plan – 03.02.16

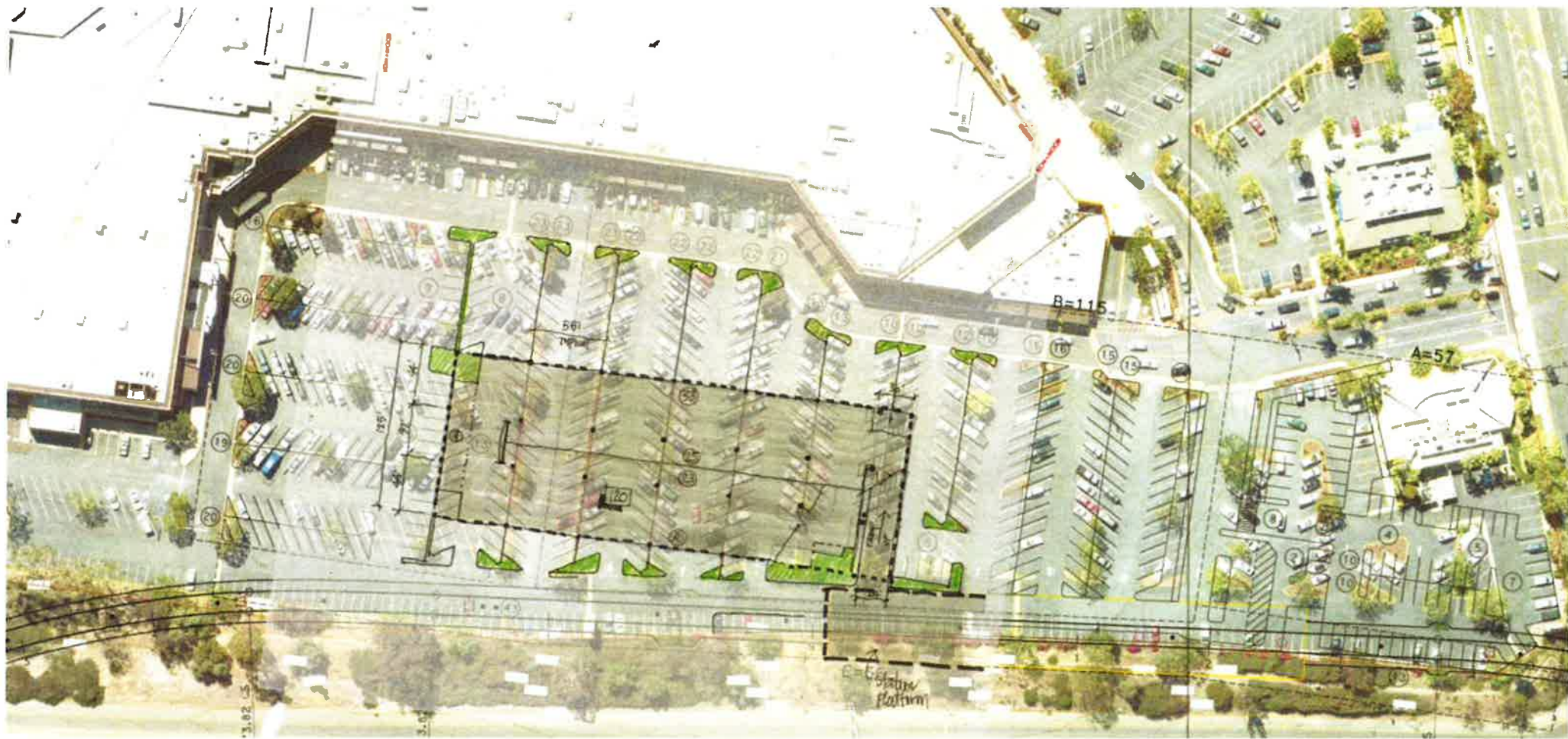

I Plate – 120 stalls



2 Plate – 123 stalls  
3 Plate – 123 stalls



Mid-Coast Corridor Transit Project		
Nobel Station Parking Analysis		
03.02.16		
Area 1	Existing Parking	MCCTP 03.02.16
A		54
B		115
C		180
D		207
E		56
<b>Total</b>	<b>773</b>	<b>612</b>
<b>Parking Replacement</b>		<b>161</b>
TPSS		4
RI/RO*		0
<b>Subtotal</b>		<b>165</b>
<b>Transt Parking</b>		<b>260</b>
<b>Total</b>		<b>425</b>
<b>Parking Structure</b>		<b>Alt.</b>
1st plate	120	120
2nd plate	123	123
3rd plate	123	123
4th plate	121	71
5th plate		
<b>Parking Structure Requires</b>		<b>487 437</b>
* Not approved by SANDAG		

4 Plate – 121 stalls

1- Plate - 120

2- Plate - 123

3- Plate - 123

4- Plate - 121

Total - 487 stalls